

MAHARASHATRA UNIVERSITY OF HEALTH SCIENCES, NASHIK

INTEGRATED KNOWLEDGE OF SUSTENABLE HEALTH
IKSHANA MUSEUM



Appeal



Lt. Gen. Madhuri Kanitkar (Retd.)
PVSM, AVSM, VSM
Vice-Chancellor
Maharashtra University of
Health Sciences, Nashik

IKSHANA is an acronym for Integrated Knowledge for Sustainable Health Awareness. It is a technical term in Vedanta and means, 'revelation of the created and in Sanskrit, it means sights or viewing or caring. The Museum will strive to meet its audience at different backgrounds, and levels of expertise by exploring content at both academic and lived experience level. IKSHANA Museum is dedicated to showcasing and developing an understanding of integrated health that will shape a health consciousness in the public. The

museum explores the thematic of medical systems, health institutions, history and planetary health to address and create awareness of socio-technical facets of health in society and especially in aspiring students. Let's strive to make this unique mission happen.

Vision

To develop an understanding and respect for all faculties of healthcare

To raise the level of health awareness among the public and foster future healthy communities

To inspire and motivate school and college students to study the health sciences and allied branches of holistic healthcare.

Mission Statement

Engage & Educate people from all sections of society through relevant and modern methods

Create outreach for high school students from All mediums of education in Maharashtra

Engage students of All health sciences from all levels of study (UG, PG & Super Specialty)

Museum Narrative

The themes to be presented in the museum explore diverse socio-technical facets of history, practice and emerging investigations in health and medicine

- ✍ Body, mind and environment relationship for wellness
- ✍ Medicine systems, subfields & allied fields
- ✍ Socio-cultural influences on Health and Medicine
- ✍ The local, national and global health system
- ✍ From human health to planetary health
- ✍ Emerging research directions in health
- ✍ Relationship with other disciplines such as material science, technology & so on.

Design Approach

Centering accessibility and inclusivity in overarching design and individual exhibits. Designing exhibits using multimedia tools like Digital touch tables, Augmented Reality, to create interactive experiences, as well as kinetic, mechanical and tactile exhibits that aid experiential learning. Designing for continuous and repeat visitor engagement with the Museum through programmatic spaces for film screenings, live workshops, reading areas and food experiences.



Sections and Design

Instructive Digital Displays and Panels

1. Section A - History of Medicine.
2. Section B - Journey of Life - Womb to Tomb.
3. Section C - Integrated Wellness "Kal, Aaj aur Kal".
4. Section D - Multimedia Movie Hall.

Museum Masterplan

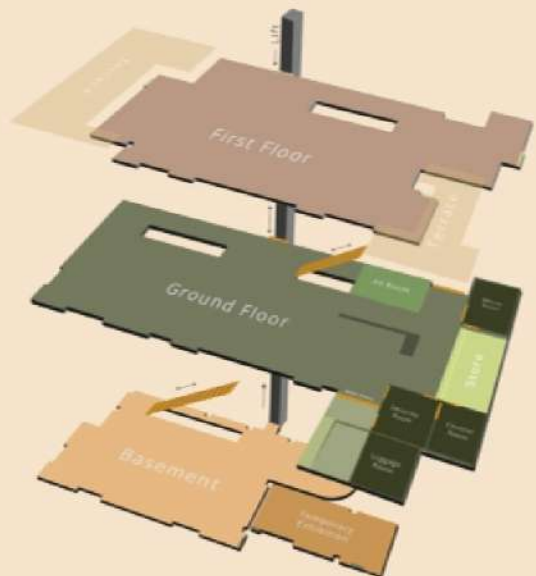
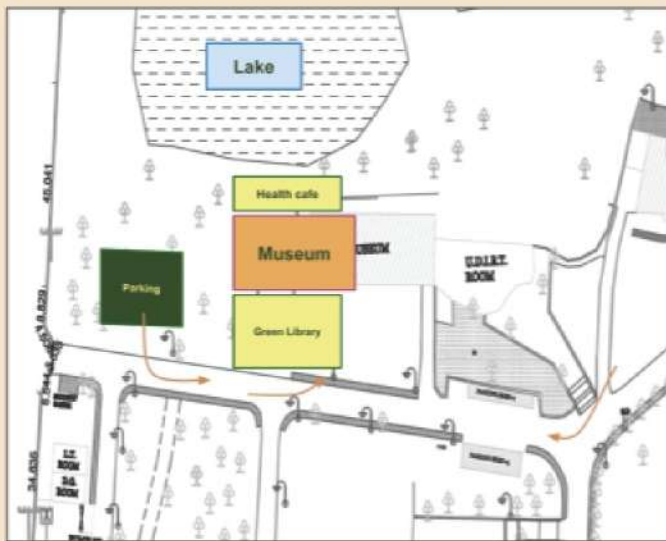

Proposed Activities

Permanent Activity Spaces

- ✍ Play-learn area for children aged 6 - 14 years old.
- ✍ Temporary exhibition gallery for presenting and integrating interdisciplinary perspectives on healthcare and medicine as practiced in India
- ✍ Green Library as an experiential space providing sensory experiences along with Five Sense Garden in background.
- ✍ Health cafe serving an amalgamation of healthy dishes and experimentation with nutritious ingredients.
- ✍ Organ Temple and Arogya Manushya Open Air Displays proposed in vicinity of the Museum.



Premises
of
Museum



IKSHANA EXPERTS

NID

The National Institute of Design (NID), Ahmedabad was set up in 1961 by the Government of India under the Ministry of Commerce and Industry, Department of Industrial Policy and Promotion, as an autonomous national institution for design, education, training, service and research. NID has gained international recognition as one of the foremost institutions in the field of design and as a catalyst for design in Indian industry. NID is also recognized as a scientific and industrial research organization by the Department of Science & Technology, Government of India. Client servicing is an integral part of NID's activity. Through our Integrated Design Services, we cater to client projects, in Design Consultancy, Industry Programmes or Outreach Projects. NID is happy to have partnered with MUHS to provide Design Consultancy Services. In IKSHANA Museum Project Team was created and NID was the Design Partner.



NCSM :

National Council of Science Museums (NCSM), an autonomous society under the Ministry of Culture, Government of India was formed on April 4, 1978. Today, it administers 26 Science Centers/Museums spread all over India. As per the recommendation of the Task Force constituted by the Union Planning Commission in the early 1970s to assess the activities of the Science Museums, NCSM initiated the process to set up National level science museums/Centers, located in metropolis, state capitals and district headquarters respectively.

NCSM, with its Headquarters in Kolkata, has its own network of 26 science museums/Centers spread across the country and a Central Research & Training Laboratory (CRTL), in Kolkata. CRTL is the Council's central hub for professional training, research and development. In addition, NCSM develops Science Centers/museums for different States and Union Territories of India. NCSM has also developed several Centers and galleries for different Govt. organizations such as ONGC, BEL, ICAR and also collaborated internationally for the development of Museum/Science Centers or for galleries such as Rajiv Gandhi Science Center, Mauritius, 'India' gallery on Buddhism at 'International Buddhist Museum', Kandy, Sri Lanka etc. NCSM is happy to have an MOU with MUHS to develop the IKSHANA Museum

Sponsorship Levels

Description and Designation for each

PATRONS Gems	Sponsorship for	Sponsorship Amount Range
DIAMOND PATRON	<p>Three Years Main Sponsors for the entire Museum project.</p> <div>  <div> <p>MUHS & Collaborative Initiative IKSHANA (Integrated Knowledge of Sustainable Health)</p> </div>  <div>Sponsor Logo</div> </div>	INR 25 Crores
PLATINUM PATRON	The complete Floor can be named by Donor with their Logo and Brand displayed boldly on the Floor & in all Brochures etc.	INR 10 Crores
GOLD PATRONS	Patron can choose the Section of the Floor that will have their Name and Logo on a Plaque at the appropriate Display area	INR 5 Crores
SILVER PATRONS	Patrons will have their Name and Logo mentioned in only one Display Area of their Choice.	INR 2.5 Crores
GREEN PATRONS	Patrons will be given a choice of Open Space Display of their Name & Logo for out-door Displays and Health Café Areas	INR 1 Crore
WHITE PATRONS	Names displayed on a Wooden Board in the Entrance and Visitor's Orientation Hall of IKSHANA Museum.	INR 50,00,000

Major Sections that can be sponsored by our Patrons:

- Ayush
- Multimedia Movie
- Organ Donation Installations
- Operation Theater / Emergency Department.
- Medicine and Surgery in Ancient India
- Roots of Western (Modern) Medicine
- Major break-thought, inventions and discoveries in Medicine
- Pharmaceutical Industry and Vaccine Development
- Learning from Wars, Natural Disasters and Pandemic
- Advances in Modern Medicine and future Technology for Healthcare

Funding and Donations will be given proper recognition and acknowledgments at IKSHANA.

Team Member / Patrons

Lt. Gen. Madhuri Kanitkar (Retd.)
PVSM, AVSM, VSM,
Vice-Chancellor, MUHS, Nashik

Prof. Dr. Milind Nikumbh
Pro-Vice-Chancellor
MUHS, Nashik

Dr. Rajendra Bangal
Registrar
MUHS, Nashik

Shri. N.V. Kalskar
Finance Accounts Officer
MUHS, Nashik

Dr. Nilima Kadambi
Consultant (Subject Expert)
IKSHANA Museum

Deans of Faculties
Dr. Vitthal N. Dhadke - Medical
Dr. Vibha Rahul Hegde - Dental
Dr. Milind B. Aavare - Ayurved & Unani
Dr. Rajkumar S. Patil - Homoeopathy
Dr. Y. Praveen Kumar - Allied

Fund Raising Committee
Dr. Parag Sancheti
Dr. Rajkumar Patil
Dr. Mrunal Patil
Dr. Swapnil Torne
Shri. Datta Nadkarni



Contact information

Dr. Swapnil Torne
Coordinator,
IKSHANA Museum

Maharashtra University of Health Sciences
Dindori Road, Mhasrul, Nashik - 422004.

Ph. :- 0253-2539175 / 176

E :- muhsmuseum@muhs.ac.in

Google Map Link

<https://maps.app.goo.gl/yo9sBU3jDaPQrJxX8>

